

# Grandville

# Forever

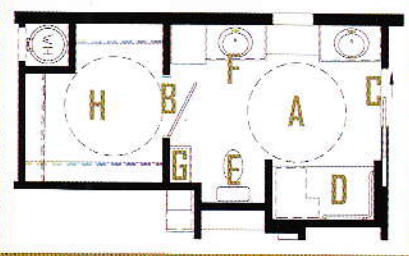

## About the Bathroom...

- A: 60" Radius**
  - o Barrier free turn zones for mobility
  - o Appliances and work areas within barrier free zones
- B: 36" Passage Ways & Lever Door Handles**
  - o Easy passage and large object moving
- C: Pocket Door Entrance**
  - o Unclutters bathroom and eases access to bath
- D: Shower Area**
  - o Barrier free entry, easy to reach hand held shower head, grab bars, and folding seat
- E: Commode**
  - o Barrier free area with comfort height, elongated toilet
- F: Vanity**
  - o Deck top area with natural light, optional accessible bases available
- G: Open Shelves**
  - o Easily store and access bathroom essentials
- H: Closet**
  - o Barrier free area with 2nd row of shelving/hanging area at lower height

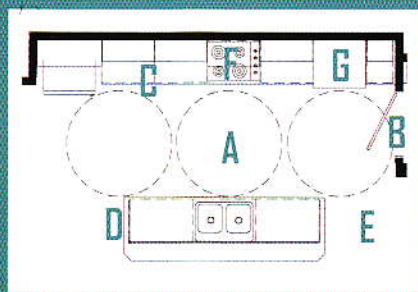

## About the Kitchen...

- A: 60" Radius**
  - o Barrier free turn zones for mobility
  - o Appliances and work areas within barrier free zones
- B: 36" Passage Ways & Lever Door Handles**
  - o Easy passage and large object moving
- C: Large Drawer Banks**
  - o Easily access cabinet items and no maneuvering around open doors
- D: Sweep D Vac**
  - o Convenient access for quick clean ups and no dust pan lines
- E: Floorite Flooring**
  - o Beautiful, maintenance free flooring, limiting "transition bars"
- F: Surface Cooktop**
  - o Accommodates optional knee space below
- G: Built-in Oven and Microwave**
  - o Located at easily accessible heights

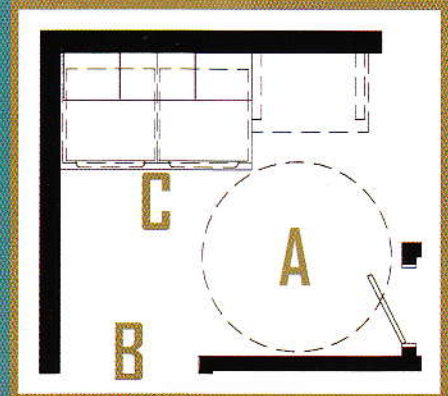

## About the Utility...

- A: 60" Radius**
  - o Barrier free turn zones for mobility
  - o Appliances and work areas within barrier free zones
- B: 36" Passage Ways & Lever Door Handles**
  - o Easy passage and large object moving
- C: Laundry Center**
  - o Elevated washer/dryer area with pull-out storage
  - o Additional storage and hanging area